

Fisher Burials in Mountain View Cemetery

Longmont, Colorado

Notes compiled by John Sutherland

May 15, 2015

Background:

Mountain View (MV) Cemetery has 22,000 + burials in 2015, and it has 36 individual Fisher family member burials, composed of either direct Fisher lines, or intermarried lines with other families. My original adventure with the Fishers (about two years ago) was to document John Harvey Fisher, our Civil War Congressional Medal of Honor (CMOH) recipient burial.

I drew up as much of the JHF family as I could, and posted an ancestral tree on Ancestry.com. Like my earlier posted Jarvis Marvin Fox family tree, I started receiving contacts from Fisher descendants with questions and comments on the tree itself, and that made me realize that I had not done a very good job of supporting the rest of the Fishers buried in Mountain View, and that led to my examination and research of the rest of the Fisher burials. It's been an interesting trip – I had no idea there were so many Fishers in the USA.



I decided to take each separate MV burial and link it to other members of the same family, using the MV cemetery records, the Longmont Genealogical Society burial records, Find-a-grave (FAG) online records, and whatever other online and Longmont Library (newspaper obituary) research sources were available. This search process included discovering unidentified Fisher members (typically women who had married into other families), tracing Fisher movements and burials all over the country, making an effort to assure that all MV Cemetery gravestones were photographed and that all appropriate Fisher Find-a-grave memorials were linked and were accurate. In order to maintain my own sanity and to assure Fisher family accuracy, I set up an Excel database into which I added specific details (date of birth, place of birth, etc.). I kept some paper records, and ended up drawing many individual family trees by hand. I tried to cross check what I had found in early obituaries with existing government records I could find among the states. It was tough - too many Fishers with the same names and similar dates.

This document is a summary of what Fisher family evidence I have been able to assemble on Mountain View burials, and I hope that you, the reader, find the information helpful. Because Find-a-Grave assigns memorial numbers to every burial, I have used the FAG numbering system to identify family members. While gathering data, I have tried to get FAG memorials around the country updated with family links and gravestone photos. To a certain extent, I have been successful, and my fingers ended up getting into many other people's FAG burial memorials. Some people also sent me supporting documents, including obituaries, from other states.

One other point to be made. The original Fisher family I addressed was that of John Harvey Fisher, and in this 2015 broad Fisher discovery process I was able to add a bit of John Harvey Fisher descendant depth that I hope will be helpful to others. In some ways I was not very successful with all of the Fisher roots, as old records and families moving around didn't always leave much of a trail of breadcrumbs to follow. I suspect that any part or all of what I have done can use some healthy scrutiny by others, especially Fisher family members – those folks who have the old family bibles, the old photos, and the old stories. I welcome that scrutiny and would welcome corrections and updates sent to me via e-mail.

Mountain View Cemetery:

It is apparent from the map (below) that Mountain View is an irregular shaped cemetery, and yes, the burial lots and spaces are sometimes irregularly located and irregularly shaped. The cemetery has grown since the late 1800s, and its design schema has changed with the passage of time. The bold numbers on the map are the Block numbers (presently 1 – 52), and the earliest burials are found in the lower numbered blocks. What is not apparent from the map is sub-block designations like Blocks 41M, 41C, and 41F, which designate upright Monuments, Center (mostly cremains), and Flat grave markers. Also, you will find some areas are unlabeled areas primarily used for babies (with smaller physical burial spaces), above ground full body burials (mausoleum) and cremains only (three current columbariums).

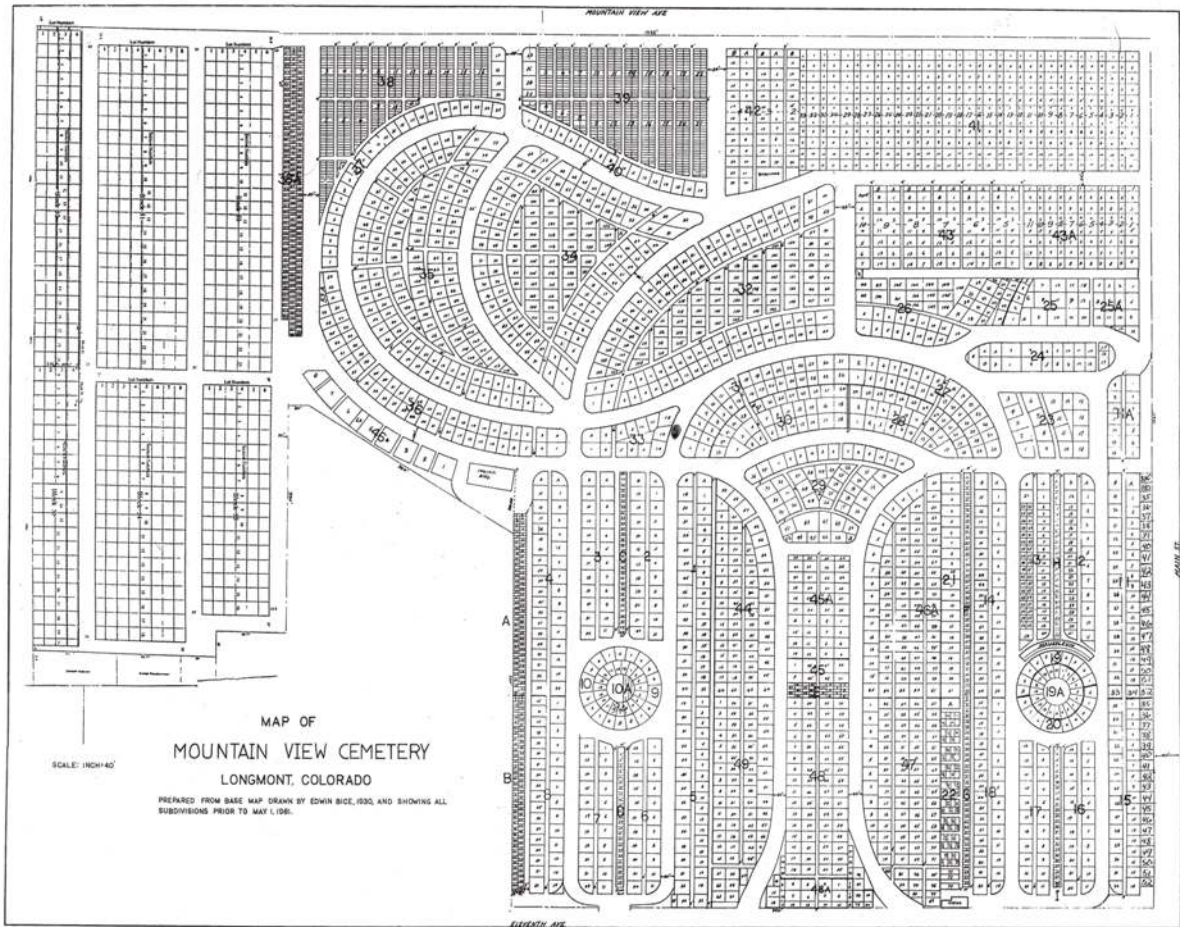

Mountain View Cemetery Office

Fisher Burial Information:

In the next section I will include individual and specific Fisher burial information and as much of the direct family links (parents, spouses) as I have been able to accumulate in the last 6-8 weeks. In addition to this Fisher burial summary document, I have created a DVD of about 500 MB of backup and supporting research material that I will provide to the cemetery office, to the Longmont Genealogical Society, and to a few Fisher family members who have requested copies. I also have accumulated a folder of paper records, including my own hand written notes that I will make available TBD. I may post a PDF copy of this particular document online at Scribd.com to enable public access and download capabilities of this document.

For MV Cemetery burial location addresses, I have used the location convention of Block, Section, Lot, and Space. There were no Fisher burials that I discovered in either the cemetery Mausoleum or in the Columbariums – all Fisher burials in this report were in-ground burials, and were either full body burials, or cremains (ashes) burials. I did not specifically identify the burial type in my research, but I did verify whether or not an actual burial was performed. Some burials do not have gravestones, but all of those Fisher MV burials that do have grave markers now have grave photos on Find-a-grave. Some also have obituaries posted.

You will find the 36 individual Fisher names in this report are listed alphabetically, starting with the person's first name. Note that this helps accommodate Fisher women with different married last names. For women marrying into the Fisher families, I have noted the woman's original surname in CAPITAL letters. I have inserted full middle names when known, rather than middle initials.

A few final introductory notes:

1. This report includes information on actual burials, and does not include reserved burial spaces (owned by Fishers but not yet used). The Excel summary sheet does include all Fishers, buried or not. And, yes, there is at least one missing body (Sarah Belle FISHER Bragg, FAG # 92906725). Sarah has passed, but I have found no evidence, specifically, of where she is buried if she is, in fact, buried.
2. Lloyd W. Fisher (FAG # 60934768) and his wife are buried in Foothills Gardens of Memory Cemetery.
3. Mildred Fisher has been associated with two different middle names: Imogene and Emogen. I have chosen to go with Imogene per a Fisher descendant suggestion.
4. Greater detailed physical cemetery burial locations can be determined from the larger cemetery map found at the cemetery office on 11th Avenue. Note also that the cemetery is planning on adding new physical Block markers in the cemetery for visitor assistance (that's a good thing).

Mountain View Cemetery

620 11th Avenue
Longmont
Boulder County
Colorado, 80501
Phone: (303) 776 – 1036
E-mail: lmvcem@hotmail.com

John Sutherland

E-mail: johns@highlander.com

Longmont Genealogical Society

P.O. Box 6081
Longmont
Boulder County
Colorado, 80501-2077
E-mail: LGS_80501@hotmail.com

Find-a-grave

www.findagrave.com

Anna FISHER Daly B32, S-SE1/4, L78, Sp2
FAG Memorial No.: 60879813
DoB: February 19, 1883
PoB: What Cheer, IA
DoD: March 3, 1974
PoD: Colorado
Father Name, FAG #: Patrick Joseph Fisher, 60881610
Mother Name, FAG #: Emeline (Emma) MAHONEY Fisher, 60881591
Spouse 1 Name, FAG#: Andrew Daly, 60879811
Spouse 2 Name, FAG #: N/A
Comments: This was a burial in which I used cemetery cards, birth and death indexes, census reports, and obituaries for Andrew Daly to establish family connections.

Arthur Fisher B32, S-NW1/4, L79, Sp1
FAG Memorial No.: 60881585
DoB: May 24, 1883
PoB: Kent, ON, Canada
DoD: January 9, 1957
PoD: Longmont, CO
Father Name, FAG #: Unknown
Mother Name, FAG #: Unknown
Spouse 1 Name, FAG#: Mildred Imogene MILES Fisher, 60881608
Spouse 2 Name, FAG #: N/A
Comments: I had good records to establish Arthur's birth, death, and marriage, but I could find no specific information on his parents (he was born in Canada, and I just didn't have the bandwidth to pursue them).

Arthur M Fisher B42, S4, L11, Sp8
FAG Memorial No.: 60881586
DoB: December 4, 1904
PoB: Detroit, MI
DoD: August 6, 1972
PoD: Longmont, CO
Father Name, FAG #: Arthur Fisher, 60881585
Mother Name, FAG #: Mildred Imogene MILES Fisher, 60881608
Spouse 1 Name, FAG#: Unknown
Spouse 2 Name, FAG #: N/A
Comments: Arthur was married, but I didn't locate his wife (she, or his mother, was referred to only as Mrs. Arthur Fisher on the cemetery cards). Arthur's mother and father were relatively easily tracked via the obituaries. Arthur was married, as his obituary did reference his mother and his children, but there was no reference to his wife. Perhaps a Fisher family member knows the answer.

Cal Norton Fisher B6, L4
FAG Memorial No.: 54442239
DoB: October 30, 1880
PoB: Longmont, CO
DoD: February 8, 1884
PoD: Longmont, CO
Father Name, FAG #: Patrick Joseph Fisher, 60881610
Mother Name, FAG #: Emeline (Emma) MAHONEY Fisher, 60881591
Spouse 1 Name, FAG#: N/A
Spouse 2 Name, FAG #: N/A
Comments: Baby Cal and his death were only mentioned in a society 'thanks' article in the Longmont Ledger, dated Feb 15, 1884. There was no obituary.

Charles C Fisher B38, L6, Sp17
FAG Memorial No.: 60881574
DoB: January 2, 1864
PoB: Illinois (or St. Louis)
DoD: November 13, 1036
PoD: Dacono, CO
Father Name, FAG #: Rev John Wesley Fisher, 53572483
Mother Name, FAG #: Susan EDWARDS Fisher, no FAG found
Spouse 1 Name, FAG#: Unknown, if any
Spouse 2 Name, FAG #: N/A

Comments: Charles was one of those burials with an incorrect name spelling (Fischer). I found what I believe to be his father and mother on census reports, but no wife or family of his own. There is also some confusion regarding his birth location. His obit says St. Louis, and his census reports all reference Illinois. Charles has no gravestone, and his is the only name on his cemetery card.

Denise Lynette Fisher B41M, S19, L11, Sp4
FAG Memorial No.: 60881588
DoB: April 23, 1973
PoB: Longmont, CO
DoD: November 3, 1998
PoD: Denver, CO
Father Name, FAG #: Lloyd Fisher, no FAG found
Mother Name, FAG #: Virginia Cook, no FAG found
Spouse 1 Name, FAG#: N/A
Spouse 2 Name, FAG #: N/A

Comments: Denise had only her obituary for reference, and, according to Ahlberg Funeral Home, her mother, Virginia Cook, crafted the obituary. It appears that Denise's parents had been divorced and that her mother was living in Omaha at the time of Denise's death. I don't know whether Cook is Virginia's maiden name or her new married name - I couldn't track her down - she may still be alive. Lloyd Fisher may also still be alive.

Elizabeth FISHER Wagner B25, L2, Sp6
FAG Memorial No.: 60886529
DoB: July 8, 1900
PoB: Russia
DoD: January 26, 1976
PoD: Denver, CO
Father Name, FAG #: Jacob Fisher, 46103083
Mother Name, FAG #: Mary E GORR Fisher, 46103084
Spouse 1 Name, FAG#: Peter Wagner, 60886563
Spouse 2 Name, FAG #: N/A

Comments: Elizabeth was tracked down during the research on Jacob Fisher (the son), and her connection with Jacob and Mary Fisher are by way of her obituary.

Elsie COMONSKY Fisher B39, L4, Sp9
FAG Memorial No.: 27168579
DoB: June 24, 1883
PoB: Scranton, PA
DoD: February 21, 1956
PoD: Firestone, CO
Father Name, FAG #: Unknown
Mother Name, FAG #: Unknown
Spouse 1 Name, FAG#: Thomas Clelland Fisher, 15503540
Spouse 2 Name, FAG #: N/A

Comments: Elsie was the second wife of Thomas Clelland Fisher (1864-1955) and step-mother to Katherine Ellen Fisher (1899-1982). Information on Elsie came from her obit, her cemetery cards, and her FAG information from Ken Mumper (aka Jupiter).

Emeline (Emma) MAHONEY Fisher B38, L8, Sp18
FAG Memorial No.: 60881591
DoB: June 15, 1860
PoB: Hampton, IL
DoD: December 15, 1932
PoD: Frederick, CO
Father Name, FAG #: John Mahoney, 98000780
Mother Name, FAG #: Elizabeth SHIELDS Mahoney, 98000787
Spouse 1 Name, FAG#: Patrick Joseph Fisher, 60881610
Spouse 2 Name, FAG #: N/A

Comments: Emma was tracked down by cemetery cards, two obits, and Internet searches.

Frances Rose HIGGINS Fisher B29, S-N1/2, L31, Sp4
FAG Memorial No.: 60881592
DoB: April 10, 1867
PoB: Memphis, TN
DoD: May 6, 1944
PoD: Longmont, CO
Father Name, FAG #: Charles A Higgins, 120744663
Mother Name, FAG #: Florida Caroline "Carrie" SEAT Higgins, 133678824
Spouse 1 Name, FAG#: John W. Fisher, 60881601
Spouse 2 Name, FAG #: Frank Ellsworth Fisher, 60881593

Comments: This was one of the more challenging Fishers to track down accurately. I did draw up manual family trees. Francis married two Fisher brothers, and yes, that was initially confusing. The spelling of her mother's maiden name (SEAT) is still questionable, and her own birth in Memphis has not been substantiated by government documents. But, Frances does have a gravestone, and that is helpful.

Frank Ellsworth Fisher B29, S-N1/2, L31, Sp3
FAG Memorial No.: 60881593
DoB: July 12, 1865
PoB: Illinois
DoD: June 16, 1946
PoD: Longmont, CO
Father Name, FAG #: George W, Fisher, 60881594
Mother Name, FAG #: Mary M BILLMAN Fisher, 60881607
Spouse 1 Name, FAG#: Frances Rose HIGGINS Fisher, 60881592
Spouse 2 Name, FAG #: N/A
Comments: Frank was relatively straight forward once Frances Rose HIGGINS Fisher had been sorted out. Obituary, census reports, cemetery cards all helped, as did the gravestone verbiage.

Gayle FISHER Moreland B41M, S6, L5, Sp3
FAG Memorial No.: 60874804
DoB: January 24, 1901
PoB: Indianola, IL
DoD: December 31, 1962
PoD: Boulder, CO
Father Name, FAG #: Eddymont M Fisher, 40629619
Mother Name, FAG #: Ida Della MADDOX Fisher, 40629739
Spouse 1 Name, FAG#: Oscar Evarts Moreland, 99990054
Spouse 2 Name, FAG #: N/A
Comments: This is/was another not-easily detailed burial, largely because the death occurred outside Longmont. It turns out that Gayle died in Boulder in 1962 and was initially buried in Boulder, CO. Her body was transferred on May 14, 1993 to Mountain View Cemetery, Longmont, where she now rests. Gayle's Find-a-grave memorial has her primary family connections listed.

George W Fisher B28, S-W1/2, L13
FAG Memorial No.: 60881594
DoB: January, 1833
PoB: Vigo, IN
DoD: May, 1912
PoD: Colorado
Father Name, FAG #: James Fisher, 43204645 (?)
Mother Name, FAG #: Lavice BOOTH Fisher, no FAG found
Spouse 1 Name, FAG#: Mary M BILLMAN Fisher, 60881607
Spouse 2 Name, FAG #: N/A
Comments: George's parents appear to be James Warford Fisher and Lavice BOOTH Fisher, but this finding needs to be verified somehow. George does not have a marked grave.

Harriet (Hattie) Fisher B17, S-E1/2, L3, Sp1
FAG Memorial No.: 47045259
DoB: May, 1890
PoB: Ohio
DoD: August 21, 1906
PoD: Denver, CO
Father Name, FAG #: John Harvey Fisher, 6860090
Mother Name, FAG #: Harriet Lucy INGLE Fisher, 47045201
Spouse 1 Name, FAG#: N/A
Spouse 2 Name, FAG #: N/A
Comments: This is John Harvey Fisher's daughter. Hattie died at age 15 years and is buried in the family plot.

Harriet Lucy INGLE Fisher

B17, S-E1/2, L3, Sp2
FAG Memorial No.: 47045201
DoB: January, 1848
PoB: Ohio
DoD: May 13, 1911
PoD: Denver, CO
Father Name, FAG #: William Ingle, no FAG found
Mother Name, FAG #: Jane PORRIT Ingle, no FAG found
Spouse 1 Name, FAG#: John Harvey Fisher, 6860090
Spouse 2 Name, FAG #: N/A

Comments: Harriet was part of my earlier John Harvey Fisher research. Harriet was pretty easy to find, but I could find no burial information on FAG for her parents. In the 1880 (census) the parents were living with their son Chrispin in Adel, Dallas, IA. Harriet is buried next to John Harvey Fisher.

Harry Fisher

B32, S-N1/2, L120, Sp2
FAG Memorial No.: 60881598
DoB: January 1, 1894
PoB: Illinois
DoD: February 17, 1953
PoD: Las Vegas, NV
Father Name, FAG #: Patrick Joseph Fisher, 60881610
Mother Name, FAG #: Emeline (Emma) MAHONEY Fisher, 60881591
Spouse 1 Name, FAG#: N/A
Spouse 2 Name, FAG #: N/A

Comments: Harry was a bachelor, and there isn't much available on him except his obituary, his military headstone application, and the 1940 census.

Ina Claire FISHER Poucher

B45, S-N1/2, L38, Sp4
FAG Memorial No.: 61014930
DoB: July 5, 1912
PoB: White City, KS
DoD: April 20, 2002
PoD: Longmont, CO
Father Name, FAG #: William Albert Fisher, 60881616
Mother Name, FAG #: Minerva (Mina) A INGMIRE Fisher, 60881609
Spouse 1 Name, FAG#: Frank Elwyn Poucher, 61014929
Spouse 2 Name, FAG #: N/A

Comments: We have burial cards and obituaries for both Ina and her husband, Frank.

Irene Fisher

B17, S-E1/2, L3, Ashes
FAG Memorial No.: 47045378
DoB: November 11, 1868
PoB: Iowa
DoD: April 6, 1945
PoD: Los Angeles, CA
Father Name, FAG #: John Harvey Fisher, 6860090
Mother Name, FAG #: Harriet Lucy INGLE Fisher, 47045201
Spouse 1 Name, FAG#: N/A
Spouse 2 Name, FAG #: N/A

Comments: Irene is John Harvey Fisher's daughter. Irene apparently never married. In 1940 (census), at the age of 71, Irene was living in Montebello, CA with her sister Ethel FISHER Brown, age 60, a widow. Both daughters had been public school teachers, and had lived in the same residence in 1935.

Jacob (Jake) Fisher B5, L27, Sp8
FAG Memorial No.: 54771950
DoB: February, 1912
PoB: Russia
DoD: August, 1913
PoD: Longmont, CO
Father Name, FAG #: Jacob Fisher, 46103083
Mother Name, FAG #: Mary E GORR Fisher, 46103084
Spouse 1 Name, FAG#: N/A
Spouse 2 Name, FAG #: N/A

Comments: Baby Jacob's date of birth was Feb, 1912 (birth location would thus have been in Russia), and date of death was Aug, 1913 in Longmont. Jacob Fisher (the father) and Mary Fisher came to Longmont from Russia in March, 1913, and baby Jacob is believed to be their baby. The Jacob Fisher family had six surviving children, three born in Russia and three born in Longmont. The family farmed near Longmont until 1932 when Jacob retired and moved to Denver. Sources: MV Cemetery ownership and burial cards, Longmont Times-Call published obituary of Jacob the father, date Jun 23, 1953, U.S. naturalization petition papers, and 1920, 1930, and 1940 federal census reports.

Jane Taylor FISHER Lincoln B12, L26
FAG Memorial No.: 60872596
DoB: October 4, 1833
PoB: Northborough, MA
DoD: May 20, 1897
PoD: Longmont, CO
Father Name, FAG #: Samuel Fisher, Jr., 95317558
Mother Name, FAG #: Mary BOWMAN Fisher, 95356762
Spouse 1 Name, FAG#: Jairus Lincoln, 60872595
Spouse 2 Name, FAG #: N/A

Comments: Early records from Massachusetts provided birth and marriage evidence. Note that the birth records used include many of the other Samuel and Mary Fisher children. Census and obituary also helped.

John Fisher B32, S-N1/2, L120, Sp3
FAG Memorial No.: 60881602
DoB: June 26, 1890
PoB: Carbon, WY
DoD: February 8, 1951
PoD: Fort Logan, CO
Father Name, FAG #: Patrick Joseph Fisher, 60881610
Mother Name, FAG #: Emeline (Emma) MAHONEY Fisher, 60881591
Spouse 1 Name, FAG#: N/A
Spouse 2 Name, FAG #: N/A

Comments: Cemetery cards and obituary were all that I researched for John Fisher.

John Harvey Fisher

FAG Memorial No.: B17, L3, E1/2, Sp3
6860090
DoB: March 12, 1837
PoB: Pennsylvania
DoD: September 16, 1895
PoD: Longmont, CO
Father Name, FAG #: George W Fisher, 77542765
Mother Name, FAG #: Barbara Ann WILLIAMS Fisher, 77542764
Spouse 1 Name, FAG#: Harriet Lucy INGLE Fisher, 47045201
Spouse 2 Name, FAG #: N/A

Comments: There is a folder of material (about 160 items) used in understanding John Harvey Fisher, CMOH medal recipient, and his ancestors and descendants. There is also a family tree posted on Ancestry.com under his name.

John W Fisher

FAG Memorial No.: B14, L19, Sp5
60881601
DoB: c 1858
PoB: Ogle, IL
DoD: April 3, 1901
PoD: Longmont, CO
Father Name, FAG #: George W Fisher, 60881594
Mother Name, FAG #: Mary M BILLMAN Fisher, 60881607
Spouse 1 Name, FAG#: Frances Rose HIGGINS Fisher, 60881592
Spouse 2 Name, FAG #: N/A

Comments: John W was the first of two Fisher brothers married by Frances Higgins. The couple had three children. Available were a 1920 census, a brief death notice, and a gravestone as primary evidence. The rest took research, family mapping, and correspondence with other researchers.

Lucy NEEDHAM Fisher

FAG Memorial No.: B23, S-N8, L18, Sp1
60881606
DoB: December 8, 1886
PoB: Lane, KS
DoD: February 28, 1962
PoD: Longmont, CO
Father Name, FAG #: John Dana Needham, 46218792
Mother Name, FAG #: Mary Catherine "Kittie" RAWSON Needham, 46218851
Spouse 1 Name, FAG#: Rev Rollo Jayne Fisher, 60881612
Spouse 2 Name, FAG #: N/A

Comments: Lucy's obituary and the 1900 census led to finding her parents and family.

Mary M BILLMAN Fisher

FAG Memorial No.: B28, S-W1/2, L13
60881607
DoB: July, 1836
PoB: Ohio
DoD: February 21, 1907
PoD: Longmont, CO
Father Name, FAG #: Unknown
Mother Name, FAG #: Unknown
Spouse 1 Name, FAG#: George W Fisher, 60881594
Spouse 2 Name, FAG #: N/A

Comments: I worked on Mary and her husband George a lot. I never did identify Mary's parents. Because of the 1860 and 1880 census, I was able to identify George and Mary's children. This is another "better solved by a real Fisher descendant" ancestral research project. Family records may help fill in the gaps.

Mildred C FISHER Wolf B42, S4, L12, Sp4
FAG Memorial No.: 60887523
DoB: August 29, 1905
PoB: Plymouth, MI
DoD: February 21, 1999
PoD: Longmont, CO
Father Name, FAG #: Arthur Fisher, 60881585
Mother Name, FAG #: Mildred Imogene MILES Fisher, 60881608
Spouse 1 Name, FAG#: Carl G Wolf, 60887518
Spouse 2 Name, FAG #: N/A
Comments: This burial was searched for using burial cards and obituaries.

Mildred Imogene MILES Fisher B32, S-NW1/4, L79 Sp2
FAG Memorial No.: 60881608
DoB: October 5, 1880
PoB: Gore, MI
DoD: March 23, 1977
PoD: Longmont, CO
Father Name, FAG #: James Edwin Miles, 11737871
Mother Name, FAG #: Catherine E LEIGHTON Miles, 11737870
Spouse 1 Name, FAG#: Arthur Fisher, 60881585
Spouse 2 Name, FAG #: N/A
Comments: This was one of the more confusing burials, mainly because of middle name confusion (Imogene or Emogen) found on different records. And, because James Edwin Miles was one of the first four people to settle Port Hope, perhaps a family history search would seem in order.

Minerva (Mina) A INGMIRE Fisher B45, S-N1/2, L38, Sp4
FAG Memorial No.: 60881609
DoB: February 21, 1879
PoB: Morris County, KS
DoD: January 8, 1958
PoD: Longmont, CO
Father Name, FAG #: Franklin Ingmire, 60884613
Mother Name, FAG #: Frances A. Ingmire, 60884612
Spouse 1 Name, FAG#: William Albert Fisher, 60881616
Spouse 2 Name, FAG #: N/A
Comments: Once the nickname and the formal name questions were resolved, Mina was fairly easy to track, although doing up a manual family tree was quite helpful. Mina and her husband were another fifty year wedding anniversary couple.

Patrick Fisher B38, L14, Sp22
FAG Memorial No.: 60881611
DoB: August 19, 1888
PoB: Carbon, WY
DoD: February, 1942
PoD: Frederick, CO
Father Name, FAG #: Patrick Joseph Fisher, 60881610
Mother Name, FAG #: Emeline (Emma) MAHONEY Fisher, 60881591
Spouse 1 Name, FAG#: N/A
Spouse 2 Name, FAG #: N/A
Comments: Patrick was a coal miner and is not believed to have been married. Son of Patrick Joseph Fisher and Emma Fisher, he was one of the children that had to be identified and sorted from census reports, military records, etc.

Patrick Joseph Fisher

B38, L8, Sp36
FAG Memorial No.: 60881610
DoB: September 27, 1852
PoB: Lansford, PA
DoD: November 6, 1940
PoD: Frederick, CO
Father Name, FAG #: Unknown
Mother Name, FAG #: Unknown
Spouse 1 Name, FAG#: Emeline (Emma) MAHONEY Fisher, 60881591
Spouse 2 Name, FAG #: N/A

Comments: Most of the information gathered about Patrick Joseph Fisher was census reports and his obituary. Online searching didn't help identify his parents, nor did it help identify his son Cal. Again, a manual tree diagram helped keep the family members sorted out. Additional Fisher descendent research would help.

Rev Rollo Jayne Fisher

B23, S-N8, L18, Sp2
FAG Memorial No.: 60881612
DoB: March 7, 1881
PoB: Schoolcraft, MI
DoD: January 8, 1961
PoD: Longmont, CO
Father Name, FAG #: Joseph Fisher, 23780023
Mother Name, FAG #: Jane COOPER Fisher, 23780021
Spouse 1 Name, FAG#: Lucy NEEDHAM Fisher, 60881606
Spouse 2 Name, FAG #: N/A

Comments: Rollo's obituary was very helpful, as was the 1900 census.

Rose M JOHNSON Fisher

B37, S-S1/2, L1
FAG Memorial No.: 60881613
DoB: June, 1899
PoB: Boulder, CO
DoD: May, 1924
PoD: Unknown
Father Name, FAG #: Andrew W Johnson, 32950415
Mother Name, FAG #: Christina HANSON Johnson, 32950449
Spouse 1 Name, FAG#: Unknown Fisher
Spouse 2 Name, FAG #: N/A

Comments: Rose didn't live very long, so the most I could find was good census reports and cemetery records. I never did figure out which Fisher she was married to, when she was married, or where she died. No obits that I could find. Another good Fisher family research project, eh?

Rosetta FISHER Dean

B28, S-W1/2, L13
FAG Memorial No.: 60880110
DoB: June 20, 1857
PoB: Ogle, IL
DoD: June 23, 1919
PoD: Longmont, CO
Father Name, FAG #: George W Fisher, 60881594
Mother Name, FAG #: Mary M BILLMAN Fisher, 60881607
Spouse 1 Name, FAG#: Andrew D Dean, no FAG
Spouse 2 Name, FAG #: N/A

Comments: No gravestone, no obituary (just a death notice), no husband Findagrave memorial found. This is an incomplete record.

Thomas Clelland Fisher

B39, L4, Sp10
FAG Memorial No.: 15503540
DoB: December 17, 1864
PoB: Glasgow, Scotland
DoD: December 8, 1955
PoD: Firestone, CO
Father Name, FAG #: John Fisher, No FAG, died in Scotland
Mother Name, FAG #: Annie Clelland Fisher, 8072566
Spouse 1 Name, FAG#: Ellen HANRATY Collins Fisher, 15503718
Spouse 2 Name, FAG #: Elsie COMONSKY Fisher, 27168579

Comments: Thomas was easy because of the bio on his FAG memorial page. I did notice an anomaly in the spelling of his middle name (based on his mother's maiden name) and that was cleared up by the FAG owner (Jupiter) sending me a copy of Thomas' Scottish birth record. Yes, there are three letter 'L' characters in Thomas' version of Clelland.

Vernon Charles Fisher

B29, S-N1/2, L31, Sp2
FAG Memorial No.: 60881615
DoB: May 14, 1895
PoB: Beaver City, NE
DoD: July 19, 1965
PoD: Longmont, CO
Father Name, FAG #: John W Fisher, 60881601
Mother Name, FAG #: Frances Rose HIGGINS Fisher, 60881592
Spouse 1 Name, FAG#: N/A
Spouse 2 Name, FAG #: N/A

Comments: Vernon was one of the three children born to John W Fisher and Frances Rose HIGGINS Fisher. The 1920 census and his obituary were very helpful in documenting him.

William Albert Fisher

B34, S-N1/2, L38, Sp3
FAG Memorial No.: 60881616
DoB: August 5, 1872
PoB: Cedar Falls, IO
DoD: May 26, 1951
PoD: Longmont, CO
Father Name, FAG #: Charles Harrison Fisher, 46921354
Mother Name, FAG #: Emma L. "Emily" NICHOLS Fisher, 46921430
Spouse 1 Name, FAG#: Minerva (Mina) A INGMIRE Fisher, 60881609
Spouse 2 Name, FAG #: N/A

Comments: There was a fair amount of information available for William, including census reports, obituary, and even a couple of photos.

Summary:

This completes the summary list of actual and physical Fisher burials in Mountain View Cemetery as of April, 2015. There are at least three other Fishers buried elsewhere in Longmont - they are not buried in Mountain View Cemetery, and because this is a MV Cemetery research project, I chose to leave the external Fisher burial details out of this document. If I have made mistakes on any of the burial or family information I've included herein, please let me know so that I may update this document.

I have tried to insert or request Findagrave updates and linkages into the 100 or so direct and related FAG memorials. Many of the FAG memorials have already been updated. Some have not. This process takes time.

John Sutherland

E-mail: johns@highlander.com

///